

JAMES EDWARD

Comprehensively Cared For



Alexandra Grove

Hackney, London, N4 2LQ

£575,000



2



1



1



C

Alexandra Grove



Description

Tastefully refurbished two bedroom apartment, situated on the second floor of an impressive Victorian conversion. Just a short walk to Finsbury Park Station, Clissold Park and West Reservoir Centre.

- Two Double Bedrooms
- Chain Free
- 611 sq ft
- Split Level
- Share of Freehold
- Period Conversion
- Exposed Brickwork
- Short Walk to Finsbury Park & Manor House Stations





Floor Plan

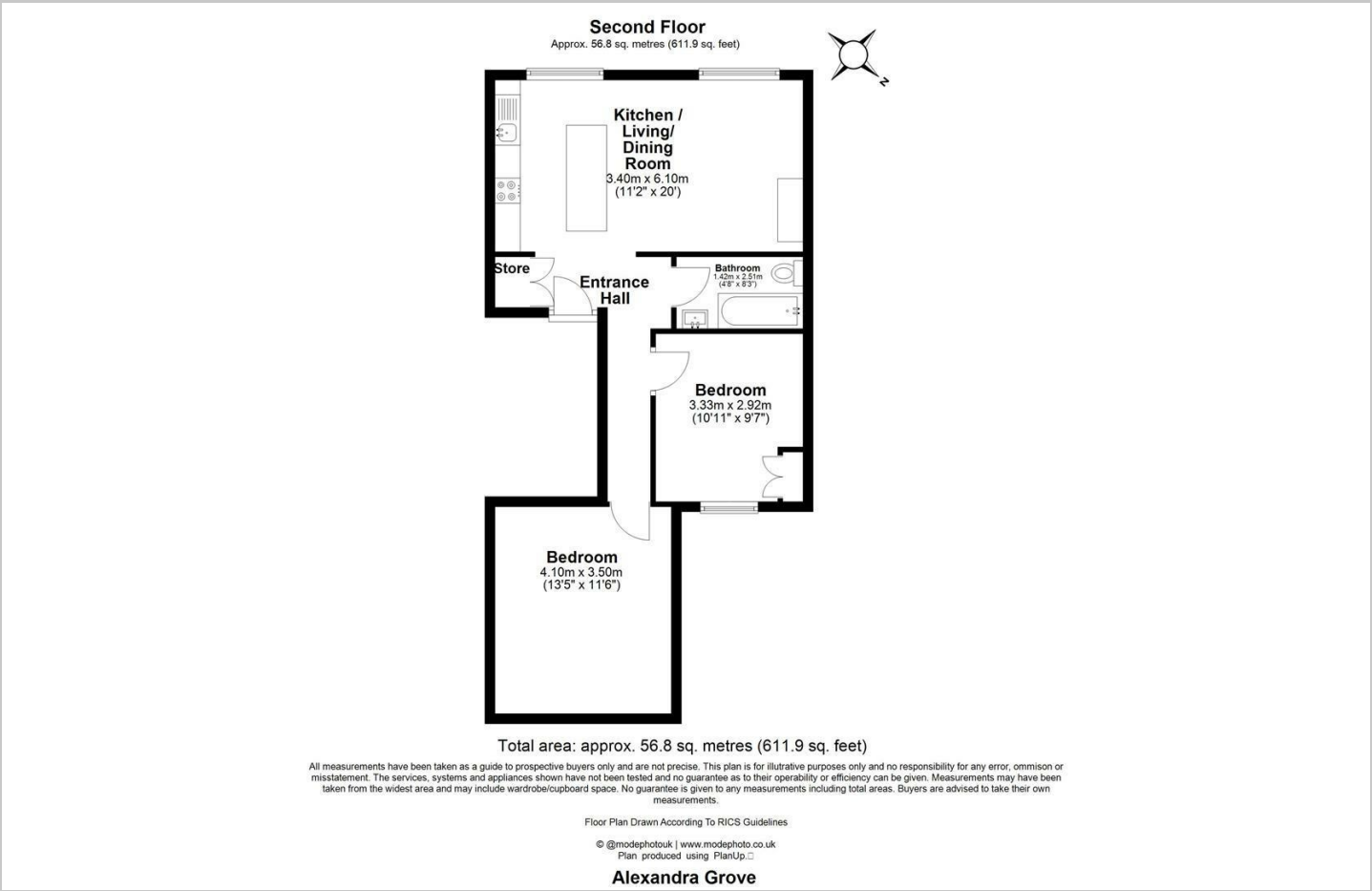

Area Map

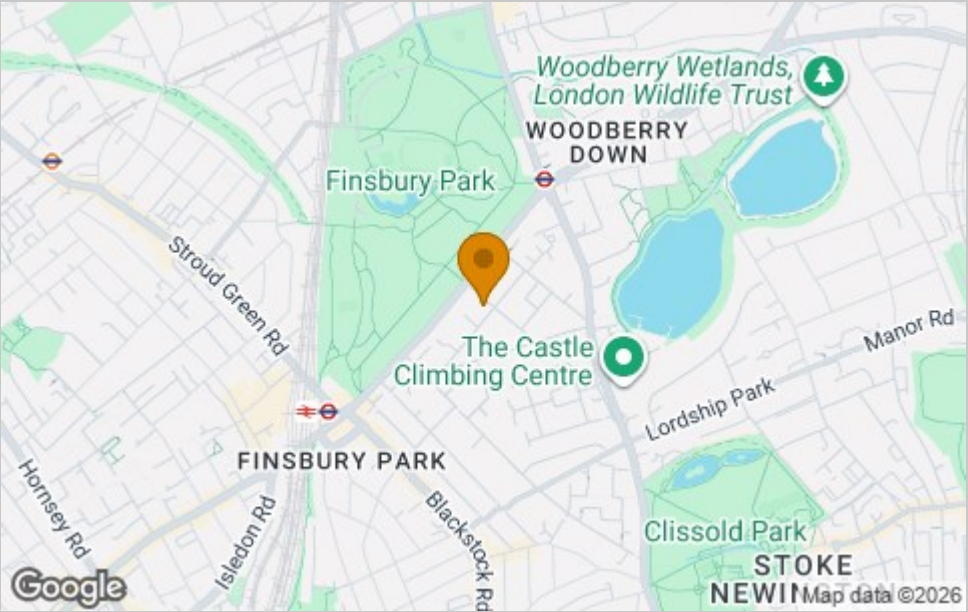

Viewing

Please contact our James Edward Office on 020 7952 5197 if you wish to arrange a viewing appointment for this property or require further information.

Energy Efficiency Graph

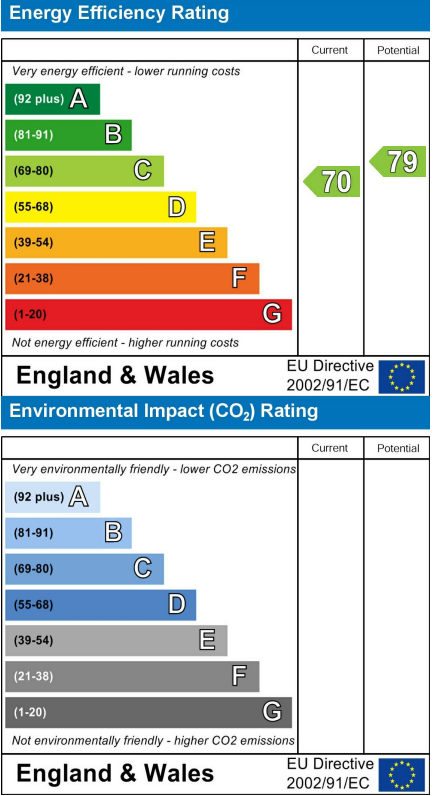

These particulars, whilst believed to be accurate are set out as a general outline only for guidance and do not constitute any part of an offer or contract. Intending purchasers should not rely on them as statements of representation of fact, but must satisfy themselves by inspection or otherwise as to their accuracy. No person in this firms employment has the authority to make or give any representation or warranty in respect of the property.